

en zh



Wiser by SE app



CCT5011-0001_AS

Wiser



Works with Wiser Hub CCT501900. Refer to system user guide for more information: https://download.schneider-electric.com/files?p_Doc_Ref=MFR1569800



- 2200 W
- 2000 W
- 500 VA
- 1000 VA

- 1050 VA
- 10 A, 140 µF
- 100 W
- LED 200 W

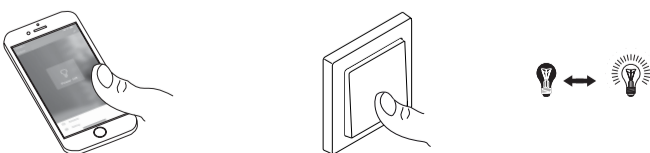
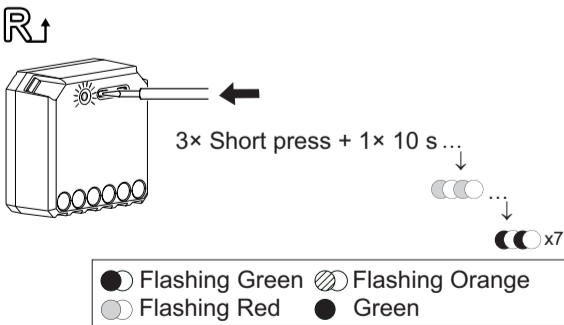
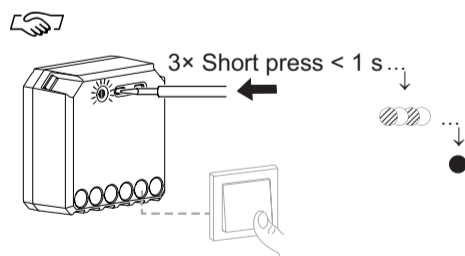
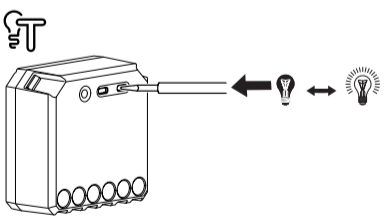
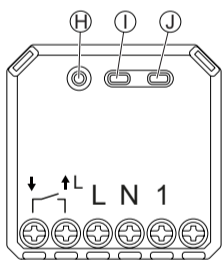
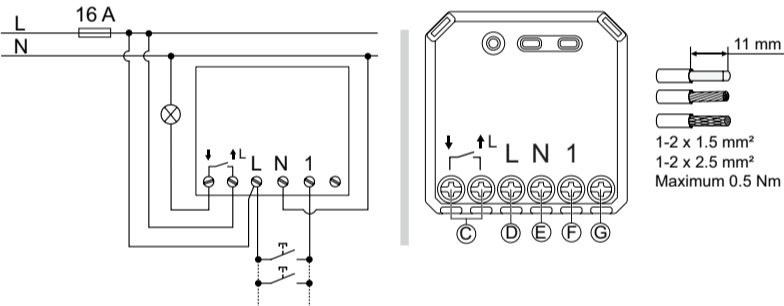
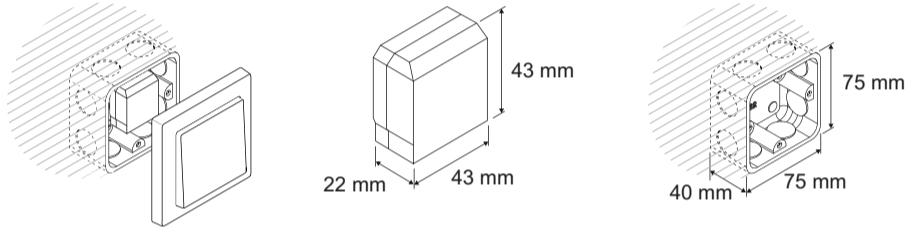
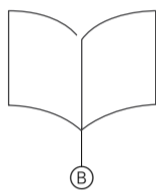
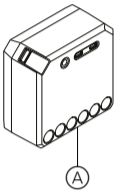

Wiser 1 Gang Micro Module Switch

CCT5011-0001_AS

For your safety

⚠️ ⚠️ DANGER

RISK OF ELECTRIC SHOCK, EXPLOSION OR ARC FLASH

- This product must only be installed and serviced by appropriately qualified and/or licenced electrical personnel.
- This product must only be used for the purpose described in these instructions and must be installed in accordance with the wiring rules and regulations in that location.
- Observe the regulations while working on live parts.
- Isolate the electrical supply before doing any work on this product.
- Ensure that the product has been correctly installed and tested for safe operation before reconnecting the electrical supply.

Failure to follow these instructions will result in death or serious injury.

Prerequisites

Scan the QR code to download the Wiser by SE app onto your smartphone to configure and control the Wiser 1 Gang Micro Module Switch.



App Store URL: <https://itunes.apple.com/us/app/wiser-by-se/id1026806919?ls=1&mt=8>



Google Play Store URL: <https://play.google.com/store/apps/details?id=com.schneiderelectric.WiserBySE>

Getting to know the product

The Wiser 1 Gang Micro Module Switch (the *module*) is used to switch the ohmic, inductive or capacitive loads. The module is actuated through the Wiser by SE app.

The module must not be used to control safety relevant applications.

Control options

Home control: To control the module in home through the Wiser by SE app, you will need the Wiser Hub.

On-site operation: The module can always be controlled directly on-site. To do this, you can connect a maximum of 10 mechanical momentary switches.

Package contents

- (A) Wiser 1 Gang Micro Module Switch
- (B) Installation instructions

Choosing the installation location

If you place the module behind a mechanical momentary switch, use a deep installation box.

Connection elements

- (C) Switch contact
- (D) Live conductor
- (E) Neutral conductor
- (F) Extension unit input 1
- (G) Unused

Mounting the module

⚠️ ⚠️ DANGER

HAZARD OF ELECTRIC SHOCK

- Make sure that the terminal connection area does not come in contact with the metallic parts of any device installed in the same location.
- Do not short the outputs to neutral.
- The switch contact and live conductor connection must be separated from one another by a 240 VAC basic insulation.

Failure to follow these instructions will result in death or serious injury.

Connecting the module

⚠️ ⚠️ DANGER

RISK OF ELECTRIC SHOCK, EXPLOSION OR ARC FLASH

- When working on the device, always disconnect the device from the power supply, as the output may carry electrical current even when the load is switched off.
- Turn off the Miniature Circuit Breaker (MCB) before installation, maintenance, or service (or replacement of the load) of the device.

Failure to follow these instructions will result in death or serious injury.

Operating elements

- (H) Status LED
- (I) Setup/Reset button
- (J) Test button

Setting the module

Testing the module

Before you couple the module or connect mechanical momentary switches, you can test the basic functions.

Connecting to the Wiser Hub

Short press the Setup/Reset button 3 times with a time interval of <1 s to connect to the available mesh. Upon successful connection to the Wiser Hub, the status LED turns green.

Resetting the module

Short press the Setup/Reset button 3 times with a time interval of <1 s and then long press the Setup/Reset button once for >10 s and <15 s to reset the module to factory default mode.

All configuration data, user data, and network data is deleted. After which:

- No connectivity to other devices or rooms
- No timer settings.

Operating the module

You can remotely control the Wiser 1 Gang Micro Module Switch through the Wiser by SE app.

Behaviour of the status LED

Refer to the system user guide.

Troubleshooting

Refer to the system user guide.

Technical data

Operating voltage	220 VAC to 240 VAC, 50/60 Hz
Power rating	⇒ W
Switching channel	1, dry contact
Standby	Maximum 0.3 W
Operating Temperature	0° C to 35° C
Neutral conductor	Required
Terminal capacity	1.5 mm to 2.5 mm (14 AWG to 13 AWG), solid or stranded types
Extension connection	Maximum 10 mechanical momentary switches, 220-240 VAC
Length of all cable	Maximum 50 m for 3-wire NYM
Sections	Cable
MCB protection	16 A circuit breaker
IP rating	IP20
Frequency band	2.4 GHz
Transmission capacity	Maximum 2.5 mW
Product Dimensions (H W D)	43 43 22 mm
Wall box Dimensions (H W D)	75 75 40 mm The wall box must have minimum 40 mm depth.
Standards	EN 60669-2-5 IEC 60669-2-5
Certification	CE compliant

Trademarks

- Apple® and App Store® are brand names or registered trademarks of Apple Inc.
 - Google Play™ Store and Android™ are brand names or registered trademarks of Google Inc.
- Other brands and registered trademarks are properties of their relevant owners.

Schneider Electric Asia Pacific Limited

11th Floor, Kerry Centre, 683 King's Road, Quarry Bay, Hong Kong

se.com/contact

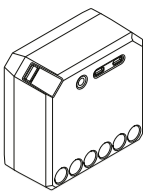

en zh



Wiser by SE app



CCT5011-0001_AS

Wiser



该产品与Wiser网关CCT501900或CCT501400_C1匹配工作请参考
https://download.schneider-electric.com/files?Doc_Ref=MFR1569800



- 2200 W
- 2000 W
- 500 VA
- 1000 VA

- 1050 VA
- 10 A, 140 μF
- 100 W
- LED 200 W

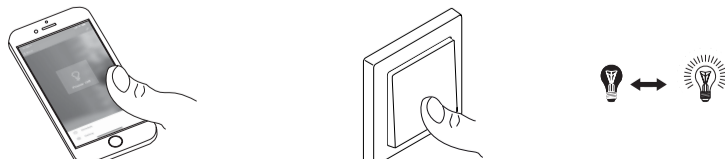
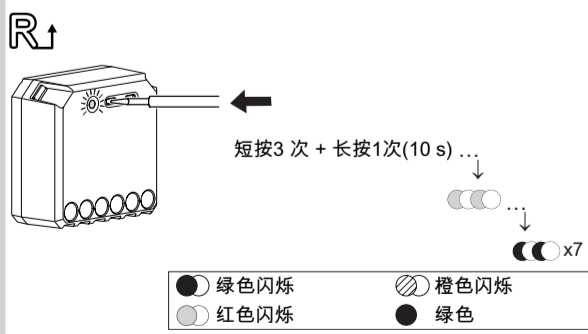
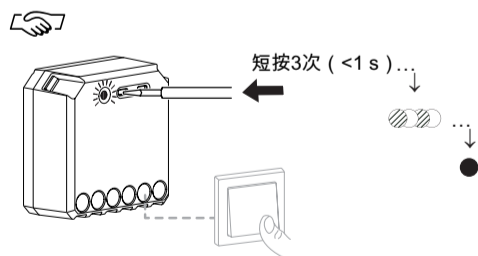
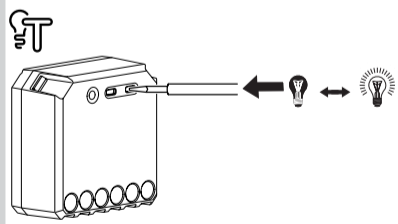
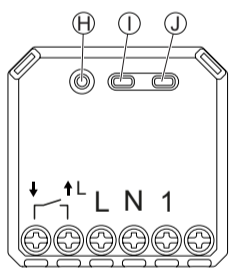
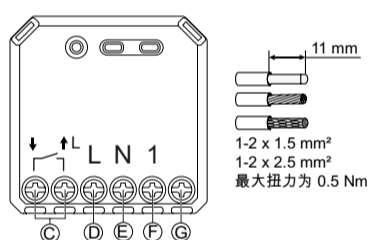
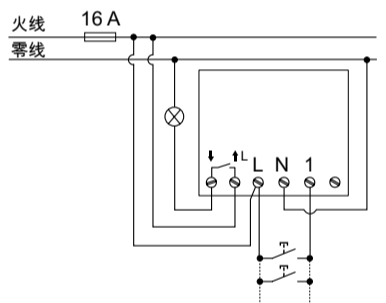
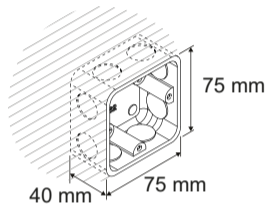
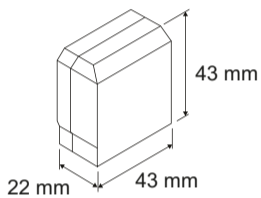
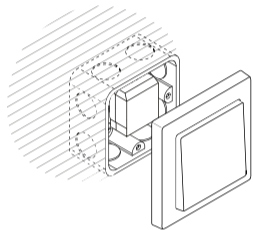
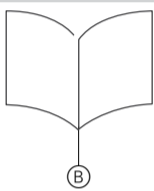
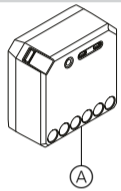

zh 智能单联开关模块
CCT5011-0001_AS

安全提示

危险

触电，爆炸或电弧闪光危险

- 本产品应仅由具有相应资质和/或获得相应证书的电气人员进行安装和维护。
- 本产品应仅用于本说明书中所述的用途，且必须根据接线规则和当地法规进行安装。
- 操作带电部件时请遵守相关规则。
- 对产品进行任何操作之前，务必切断电源。
- 重新连接电源之前，本产品必须正确安装且经过测试，确保操作的安全性。

若不遵守此说明，则可能会导致死亡或重伤。

前提条件

扫描二维码下载 Wiser by SE app 到您的智能手机，以配置和安装 Wiser Zigbee 设备。



App Store 的 URL:
<https://itunes.apple.com/us/app/wiser-by-se/id1026806919?ls=1&mt=8>



Android App 的 URL:
<https://www.schneider-electric.cn/zh/product-range-download/65750-臻尚无线智能家居/#/software-firmware-tab>

产品简介

智能单联开关模块（本模块）专用于开关电阻，电感或电容负载。此模块可以通过 Wiser by SE app 控制。

此模块不得用于控制安全相关的应用。

控制选项

家居控制：当使用 Wiser by SE app 开控制此模块时，需要使用智能ZB/IP网关

现场操作：此模块可以被直接连接的机械自复位开关控制，可以连接最多10个机械开关。

包装内容

- 智能单联开关模块
- 安装说明书

选择安装位置

如果将模块安装在机械自复位开关背面，请使用深墙盒。

连接元件

- 开关接点
- 火线接点
- 零线接点
- 外部控制端口
- 未使用

安装模块

危险

触电危险

- 确保接线端子的接线区没有与在同一安装区域的其他任何产品的金属部件相接触。
- 请勿将负载输出端和零线短接。
- 开关接点和火线接点接线区要保持 240 VAC 的基本绝缘。

若不遵守此说明，则可能会导致死亡或重伤。

连接模块

危险

触电，爆炸或电弧闪光危险

- 当在设备上操作时，请务必断开设备电源连接，因为即使是在负载关闭的情况下，在输出端也可能会有电流。
- 请在切断断路器（MCB）后再对设备执行安装，维护或维修（或负载更换）等操作。

若不遵守此说明，则可能会导致死亡或重伤。

操作元件

- LED 状态灯
- Setup/Reset 按键
- 测试按键

设置模块

测试模块

在配置或者连接机械自复位开关之前，可以对基本功能进行测试。

与智能ZB/IP网关连接

短按 Setup/Reset 按键 3 次，时间间隔<1S 以连接到可用的网状网络。成功连接到智能ZB/IP网关后，LED 状态灯变为绿色。

重置模块

短按 Setup/Reset 按键 3 次，时间间隔<1S 随后长按 Setup/Reset 按键一次适用于 >10 s - <15 s，即可将模块重置为出厂默认模式。

所有配置数据，用户数据和网络数据均被删除。之后会出现下列情况：

- 与其他设备或房间无连接
- 计时器没有进行设置。

操作模块

可以通过 Wiser by SE app 远程控制智能单联开关

模块。

LED 状态灯的行为

请参阅系统用户指南。

故障排除

请参阅系统用户指南。

技术参数

工作电压	220 VAC - 240 VAC, 50/60 Hz
额定功率	↔ W
开关接点	1. 干触点
待机功耗	最大为 0.3 W
工作温度	0°C ~ 35°C
零线	要求
接线能力	1.5 mm - 2.5 mm (14 AWG - 13 AWG), 实芯线和多股绞线
扩展连接	最多支持 10 个机械的220-240VAC自复位开关
线缆总长	3 根 NYM 线缆最长为 50 m
MCB 保护	16 A 断路器
IP 等级	IP20
频带	2.4 GHz
传输能力	最大为 2.5 mW
产品尺寸 (H × W × D)	43 43 22 mm
墙盒尺寸 (H × W × D)	75 75 40 mm 墙盒的深度至少为 40 mm。
标准	符合 EN 60669-2-5 标准 符合 IEC 60669-2-5 标准
认证	符合 CE 标准

部件名称 Part Name	有害物质					
	铅 Pb	汞 Hg	镉 Cd	六价铬 Cr(VI)	多溴联苯 PBB	多溴二苯醚 PBDE
金属件 Metal parts	x	o	o	o	o	o
塑胶件 Plastic parts	o	o	o	o	o	o
电子件 Electronic	x	o	o	o	o	o
触点 Contacts	o	o	o	o	o	o
线缆和线缆附件 Cables and cabling accessories	o	o	o	o	o	o

本表格依据 SJ/T11364 的规定编制。
o: 表示该有害物质在该部件所有均质材料中的含量均在GB/T 26572 规定的限量要求以下。
x: 表示该有害物质至少在该部件的某一均质材料中的含量超出 GB/T 26572 规定的限量要求。

This table is made according to SJ/T 11364.

o: indicates that the concentration of hazardous substance in all of the homogeneous materials for this part is below the limit as stipulated in GB/T 26572.

x: indicates that concentration of hazardous substance in at least one of the homogeneous materials used for this part is above the limit as stipulated in GB/T 26572.

商标

- Apple® 和 App Store® 是 Apple Inc. 的品牌名称或注册商标。
- Google Play™ Store 和 Android™ 是 Google Inc. 的品牌名称或注册商标。

其他品牌和注册商标均为其相关权属人的财产。

施耐德电气(中国)有限公司

北京市朝阳区望京东路六号A座

客户支持热线: 400 810 1315

se.com/contact